

ORDER NUMBER

26-018-1994



Co. Code/Seq. No./Yr. of Entry

MANAGED FOREST LAW MAP  
Form 2450-133 Rev. 4-87

MADISON OFFICE USE ONLY

Acreage Entered

Owner's Name Stone, et al, Douglas J.	Town or Village Name Saxon	County Iron
Street or Route 244 Waverly Place	Township No. 47N	Range 1E
City, State, Zip Code Waukesha WI 53186	Closed Acres 38	Open Acres 33

LEGEND: SALE →   
 AREA   
 @ AC 

Section Diagram  
8" = 1 Mile

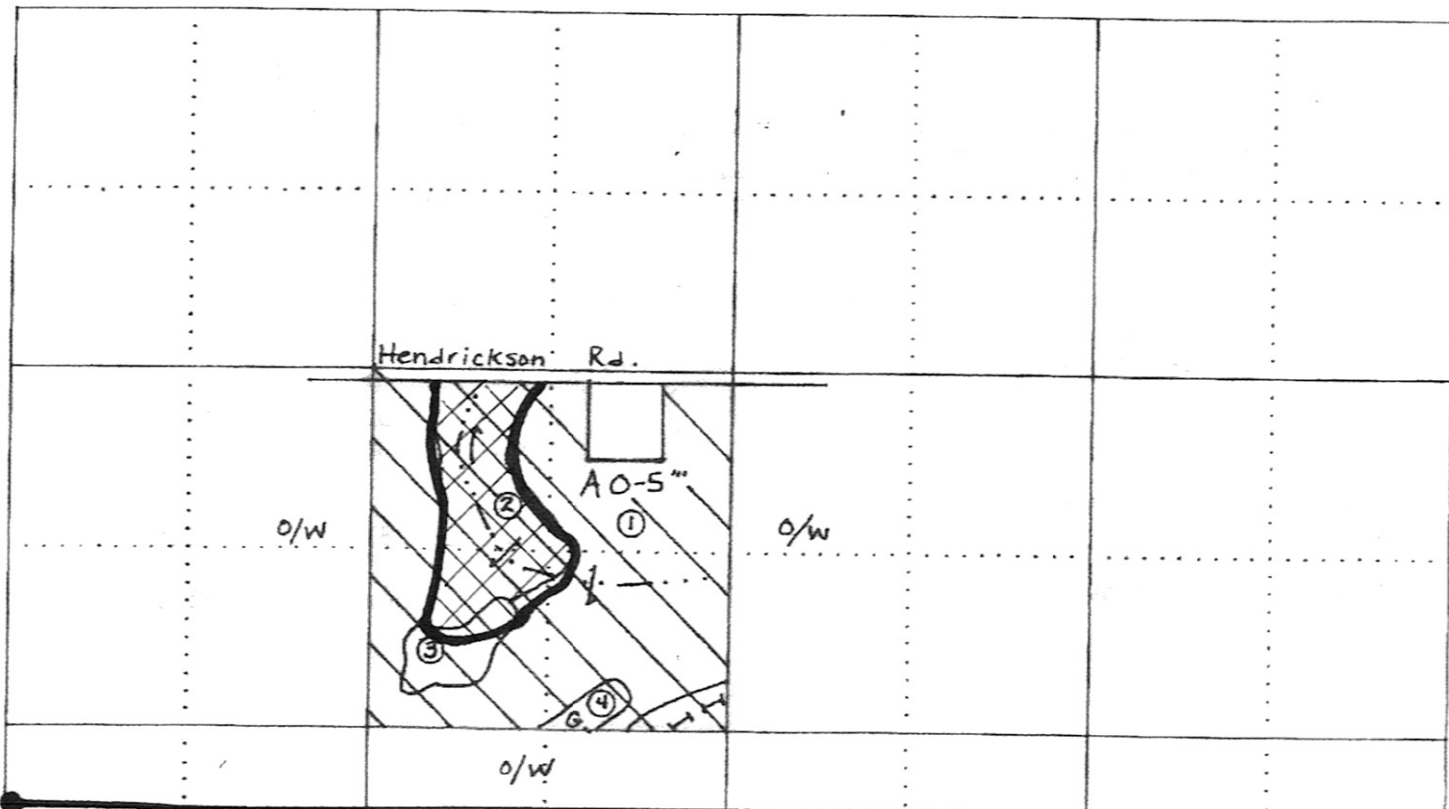
Prepared By TIM FITZGERALD

Stone, Hendrickson Rd Sale, 8 acres NH thinning

ESTIMATED VOLUMES		MINIMUM ADVERTISED BID
Mixed Hardwood	= 30cords	\$20 per cord
Ash	=20 cds	\$10 per cord
Aspen	=10 cds	\$15 per cord
Balsam Fir	=10 cds	\$10 per cord
Mixed HDWD saw	=1 MBF	\$100 per MBF

CUTTING REQUIREMENTS

Cut all trees marked with orange paint, including those trees marked less than 4" in diameter in canopy gaps. Also cut all balsam fir with 1 or more 100" pulp sticks. No cutting or skidding in April, May or June. "Sawlogs" have the following minimum specifications and include #3 logs: Minimum diameter small end, hardwoods 10.6 inches, length 8 feet; maximum scale deduction 50%. Utilize all pulpwood to a minimum 4-inch top diameter and all sawtimber to a 10-inch min top diameter. Boundaries are marked by pink ribbon. Good access off of Hendrickson road and additional logging roads subject to advance approval by Forester and WI BMP's for water quality followed. Flat, wet terrain that is bisected by stream so frozen ground will be necessary to harvest area, and timber mats maybe needed to cross wet areas. All payments will be based on Mill scale.

Bids must be a received before December 10, 2013 with a 10% bid deposit. A 20% performance bond guarantee will be required at the time the contract is signed. Send to:

Fitzgerald Forestry, 8240 N Northend Rd, Mercer, WI 54547. (715-776-0808)